



**NOTES**

- ALL LINES ARE TO BE MIN. 100Ø UPVC @ MIN 1.0% GRADE UNLESS NOTED OTHERWISE.
- IT IS THE CONTRACTORS RESPONSIBILITY TO LOCATE & LEVEL ALL EXISTING SERVICES PRIOR TO THE COMMENCEMENT OF ANY EARTHWORKS. ALL DESIGN LEVELS SHOWN ON PLAN SHALL BE VERIFIED ON SITE PRIOR TO THE COMMENCEMENT OF ANY WORK.
- ALL PIPES TO HAVE MIN 200mm COVER IF LOCATED WITHIN PROPERTY.
- ALL PITS IN DRIVEWAYS BE HEAVY DUTY GRATES. DIRECT SURFACE FLOW TO ALL GRATED SURFACE INLET PITS.
- ALL WORK DO BE DONE IN ACCORDANCE WITH AS/NZ 3500.3.2:1998 AND COUNCIL SPECIFICATIONS.
- LOCATION OF DOWNPIPES & FLOOR WASTES ARE INDICATIVE ONLY. DOWNPIPE & FLOOR WASTE SIZE, LOCATION & QUANTITY TO BE DETERMINED BY BUILDER & IN ACCORDANCE WITH RELEVANT AUSTRALIAN STANDARDS.
- THIS PLAN IS TO BE READ IN CONJUNCTION WITH THE ARCHITECTURAL, LANDSCAPE AND STRUCTURAL PLANS.
- ANY DISCREPANCIES OR OMISSIONS SHALL BE REFERRED TO THE DESIGN ENGINEER FOR RESOLUTION.
- ALL PITS OR GRATES IN TRAFFICABLE AREAS TO BE HEAVY DUTY.
- ALL GUTTERS WILL BE FITTED WITH LEAF GUARDS AND SHOULD BE INSPECTED AND CLEANED TO ENSURE LEAF LITTER CANNOT ENTER THE DOWNPIPES
- EXISTING STORMWATER DRAINAGE TO BE UTILISED WHERE CONTRACTOR SEE FIT.

**SYMBOLS**

- |          |                                   |       |                             |
|----------|-----------------------------------|-------|-----------------------------|
| RL       | PIT SURFACE LEVEL                 | ØRWO  | RAINWATER OUTLET 300Ø       |
| IL       | INVERT LEVEL                      | • DP  | DOWN PIPE                   |
| TK       | TOP OF KERB                       | • DPS | DOWN PIPE SPREADER          |
| — SW —   | STORMWATER DRAINAGE PIPE          | • CO  | CLEAN OUT                   |
| — RWT —  | DOWNPIPE TO RAINWATER TANK        | • IO  | INSPECTION OPENING          |
| — OF —   | OVERFLOW PIPE FROM RAINWATER TANK | • VD  | VERTICAL DROP               |
| — Ø100 — | Ø100 SUBSOIL PIPE                 | • VR  | VERTICAL RISER              |
| — RM —   | RISING MAIN                       | ☒     | CONCRETE COVER JUNCTION PIT |
| FW       | FLOOR WASTE 150X150               | ☐     | GRATED INLET PIT            |
| FW       | FLOOR WASTE 150Ø                  | ▨     | WIDE GRATED DRAIN           |

**DESIGN NOTES**

- LGA = CANTERBURY BANKSTOWN COUNCIL
- SCOPE OF WORKS TO INCLUDE DEMOLITION OF EXISTING DWELLING AND CONSTRUCTION OF DUAL OCCUPANCY.
- IN ACCORDANCE WITH COUNCIL GUIDELINES, NO OSD IS REQUIRED FOR SUBJECT DEVELOPMENT AS THE IMPERVIOUS AREA LESS THAN 66%
- PROPOSED RAINWATER TANK PER DWELLING AS PER BASIX SPECIFICATIONS.

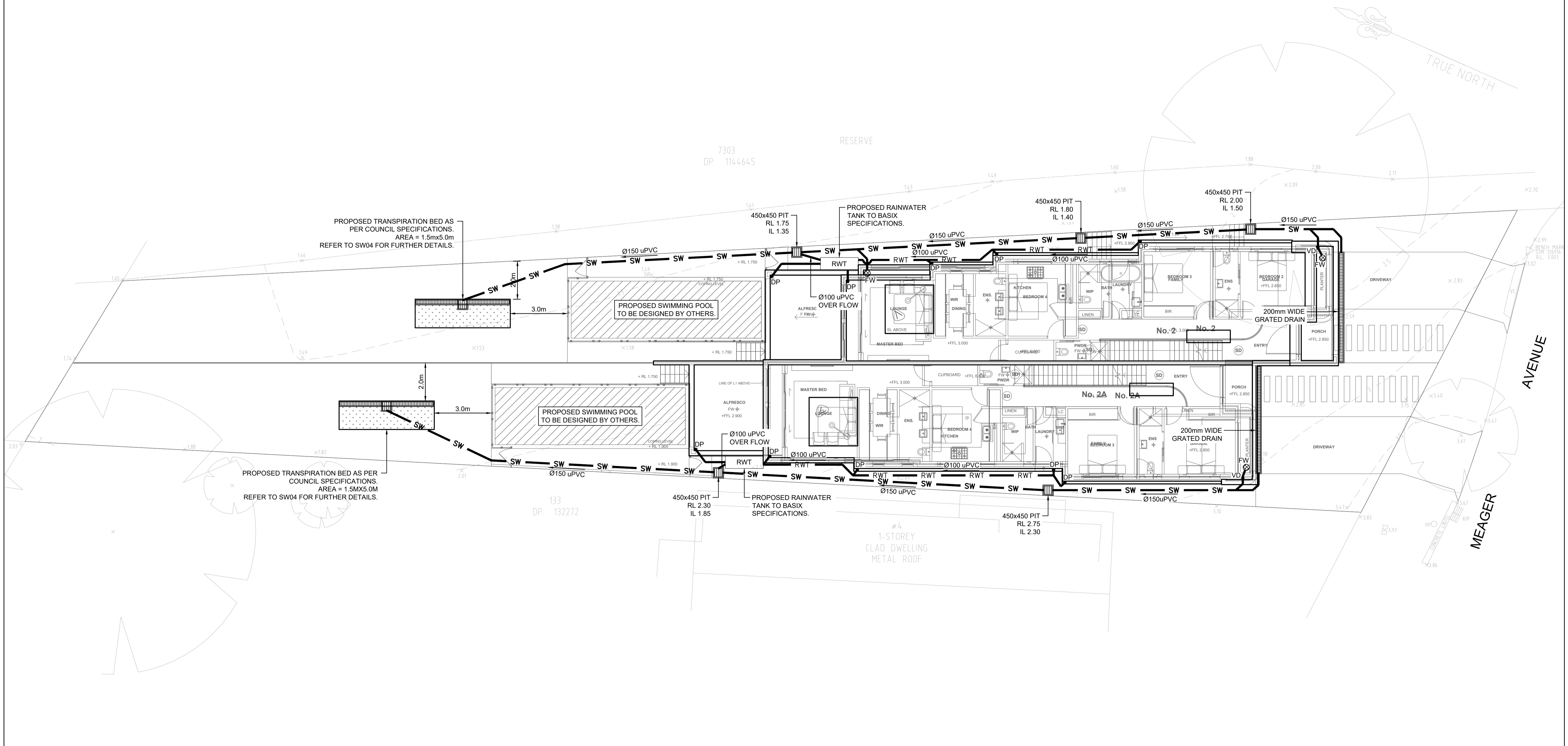

No	AMENDMENT	ENG	DRAFT	DATE
A	ISSUED FOR APPROVAL	A.E	J.L.	08.11.21

**ae CONSULTING ENGINEERS**

P: 0432 619 949  
 E: info@aeconsulting.com.au  
 W: www.aeconsulting.com.au

ARCHITECT

**RESOLUT**

p: (02) 8003 5885  
 e: info@resolut.com.au

CLIENT

TALEB HIJAZI

SHEET SUBJECT

STORMWATER DRAINAGE PLAN  
 GROUND LEVEL

PROJECT 2 MEAGER AVENUE, PADSTOW NSW 2211			
DATE	DRAWN	DESIGNED	CHECKED
08.11.2021	J.L.	J.L.	A.E.
SCALE @ A1	JOB No		
1:100 U.N.O.	D21316		
AUTHORISED	DWG No	REV	
	A.E.	SW01	A

**ISSUED FOR D.A.**

DO NOT SCALE DRAWING, USE FIGURED DIMENSIONS ONLY

This drawing remains the property of A.E CONSULTING ENGINEERS and must not be reproduced or used without written consent.



**NOTES**

- ALL LINES ARE TO BE MIN. 100Ø UPVC @ MIN 1.0% GRADE UNLESS NOTED OTHERWISE.
- IT IS THE CONTRACTORS RESPONSIBILITY TO LOCATE & LEVEL ALL EXISTING SERVICES PRIOR TO THE COMMENCEMENT OF ANY EARTHWORKS. ALL DESIGN LEVELS SHOWN ON PLAN SHALL BE VERIFIED ON SITE PRIOR TO THE COMMENCEMENT OF ANY WORK.
- ALL PIPES TO HAVE MIN 200mm COVER IF LOCATED WITHIN PROPERTY.
- ALL PITS IN DRIVEWAYS BE HEAVY DUTY GRATES. DIRECT SURFACE FLOW TO ALL GRATED SURFACE INLET PITS.
- ALL WORK DO BE DONE IN ACCORDANCE WITH AS/NZ 3500.3.2:1998 AND COUNCIL SPECIFICATIONS.
- LOCATION OF DOWNPIPES & FLOOR WASTES ARE INDICATIVE ONLY. DOWNPIPE & FLOOR WASTE SIZE, LOCATION & QUANTITY TO BE DETERMINED BY BUILDER & IN ACCORDANCE WITH RELEVANT AUSTRALIAN STANDARDS.
- THIS PLAN IS TO BE READ IN CONJUNCTION WITH THE ARCHITECTURAL, LANDSCAPE AND STRUCTURAL PLANS.
- ANY DISCREPANCIES OR OMISSIONS SHALL BE REFERRED TO THE DESIGN ENGINEER FOR RESOLUTION.
- ALL PITS OR GRATES IN TRAFFICABLE AREAS TO BE HEAVY DUTY.
- ALL GUTTERS WILL BE FITTED WITH LEAF GUARDS AND SHOULD BE INSPECTED AND CLEANED TO ENSURE LEAF LITTER CANNOT ENTER THE DOWNPIPES
- EXISTING STORMWATER DRAINAGE TO BE UTILISED WHERE CONTRACTOR SEE FIT.

**SYMBOLS**

- |                  |                                   |        |                             |
|------------------|-----------------------------------|--------|-----------------------------|
| RL               | PIT SURFACE LEVEL                 | ⊗ RWO  | RAINWATER OUTLET 300Ø       |
| IL               | INVERT LEVEL                      | • DP   | DOWN PIPE                   |
| TK               | TOP OF KERB                       | • DPS  | DOWN PIPE SPREADER          |
| — SW —           | STORMWATER DRAINAGE PIPE          | • CO   | CLEAN OUT                   |
| — RWT —          | DOWNPIPE TO RAINWATER TANK        | • IO   | INSPECTION OPENING          |
| — OF —           | OVERFLOW PIPE FROM RAINWATER TANK | • VD   | VERTICAL DROP               |
| — 10 — 10 — 10 — | Ø100 SUBSOIL PIPE                 | • VR   | VERTICAL RISER              |
| — RM —           | RISING MAIN                       | ⊠      | CONCRETE COVER JUNCTION PIT |
| ⊠ FW             | FLOOR WASTE 150X150               | ⊠      | GRATED INLET PIT            |
| ⊗ FW             | FLOOR WASTE 150Ø                  | ▬▬▬▬▬▬ | WIDE GRATED DRAIN           |

**DESIGN NOTES**

- LGA = CANTERBURY BANKSTOWN COUNCIL
- SCOPE OF WORKS TO INCLUDE DEMOLITION OF EXISTING DWELLING AND CONSTRUCTION OF DUAL OCCUPANCY.
- IN ACORDANCE WITH COUNCIL GUIDELINES, NO OSD IS REQUIRED FOR SUBJECT DEVELOPMENT AS THE IMPERVIOUS AREA LESS THAN 66%
- PROPOSED RAINWATER TANK PER DWELLING AS PER BASIX SPECIFICATIONS.

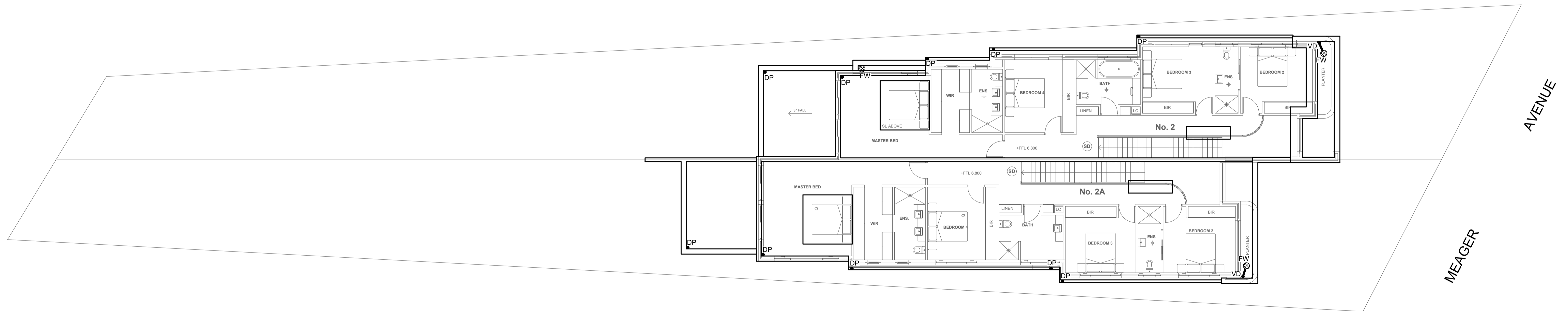

No	AMENDMENT	ENG	DRAFT	DATE
A	ISSUED FOR APPROVAL	A.E	J.L.	08.11.21

**ae CONSULTING ENGINEERS**

P: 0432 619 949  
 E: info@aeconsulting.com.au  
 W: www.aeconsulting.com.au

ARCHITECT

**RESOLUT**

p: (02) 8003 5885  
 e: info@resolut.com.au

CLIENT  
 TALEB HIJAZI

SHEET SUBJECT  
 STORMWATER DRAINAGE PLAN  
 FIRST LEVEL

PROJECT 2 MEAGER AVENUE, PADSTOW NSW 2211			
DATE 08.11.2021	DRAWN J.L.	DESIGNED J.L.	CHECKED A.E.
SCALE @ A1 1:100 U.N.O.		JOB No D21316	
AUTHORISED A.E.		DWG No SW02	REV A

**ISSUED FOR D.A.**

DO NOT SCALE DRAWING, USE FIGURED DIMENSIONS ONLY

This drawing remains the property of A.E CONSULTING ENGINEERS and must not be reproduced or used without written consent.

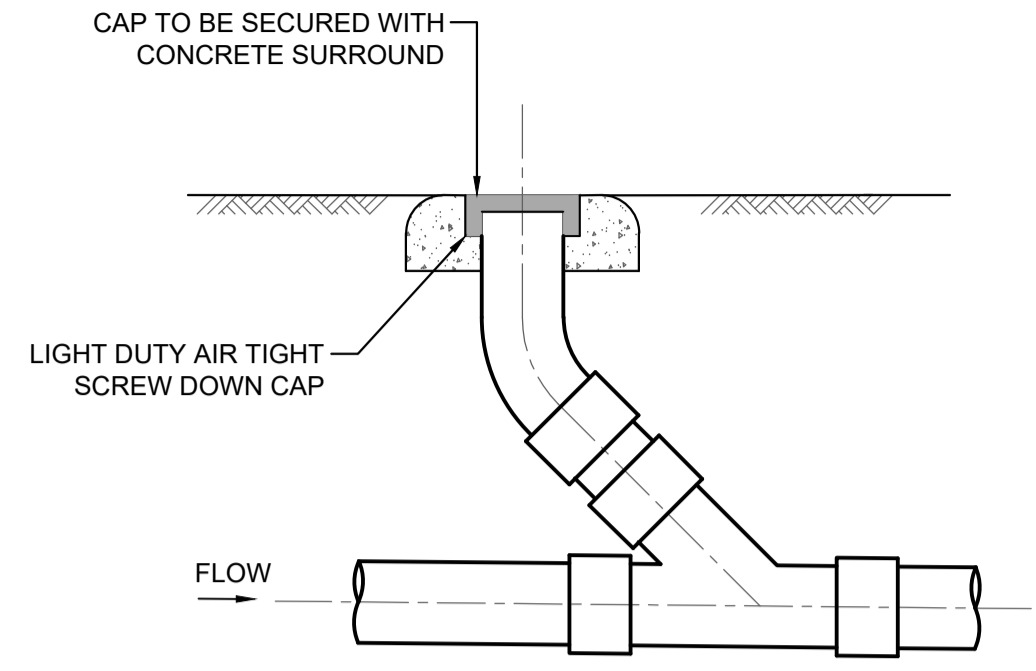

TYPICAL CLEANING EYE DETAIL  
SCALE NTS

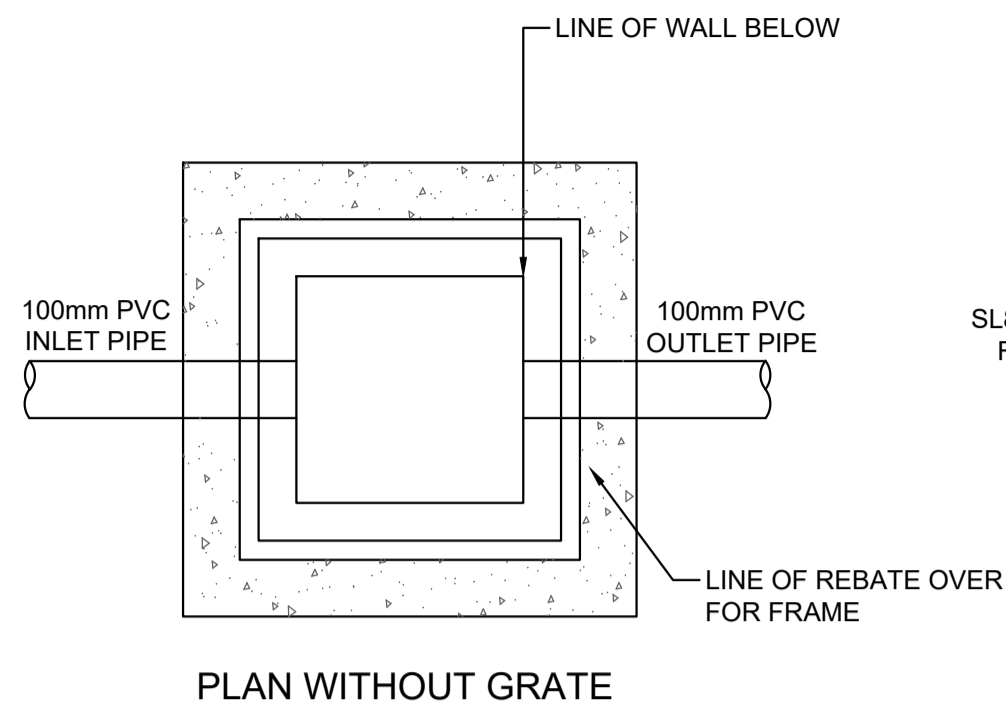

DETAIL  
STORMWATER PIT  
SCALE NTS

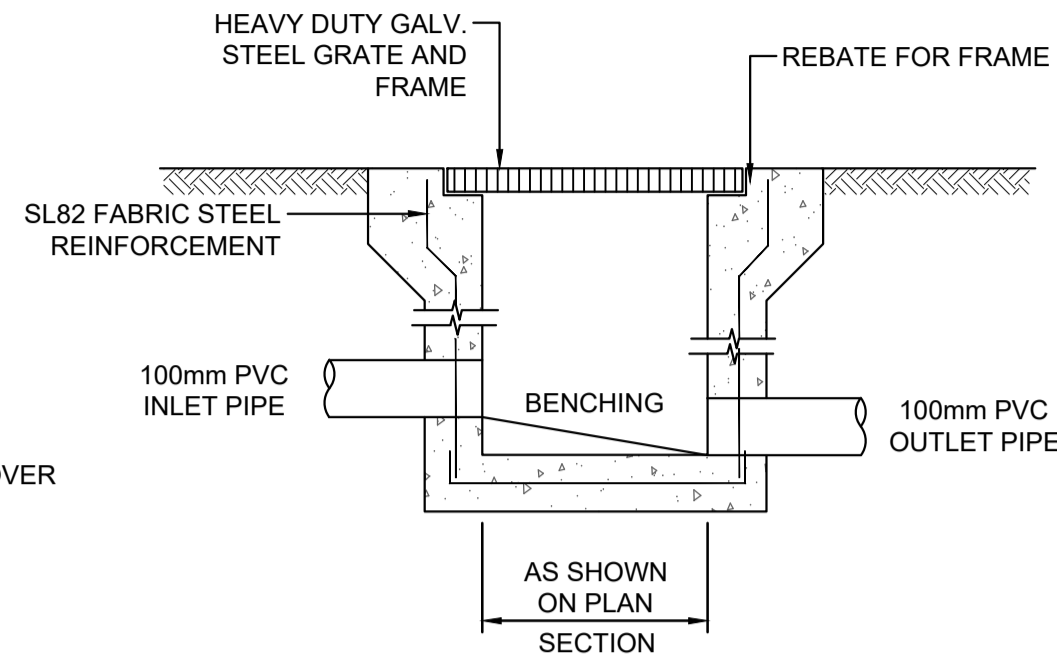

TYPICAL RAINWATER TANK DETAIL  
NOT TO SCALE

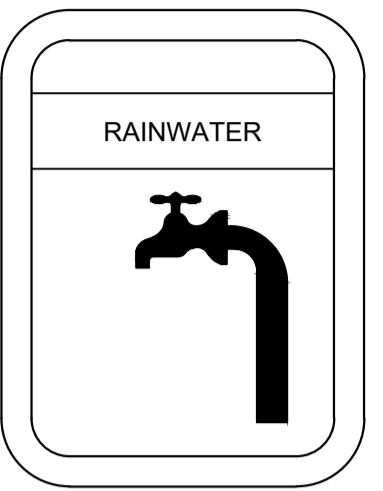
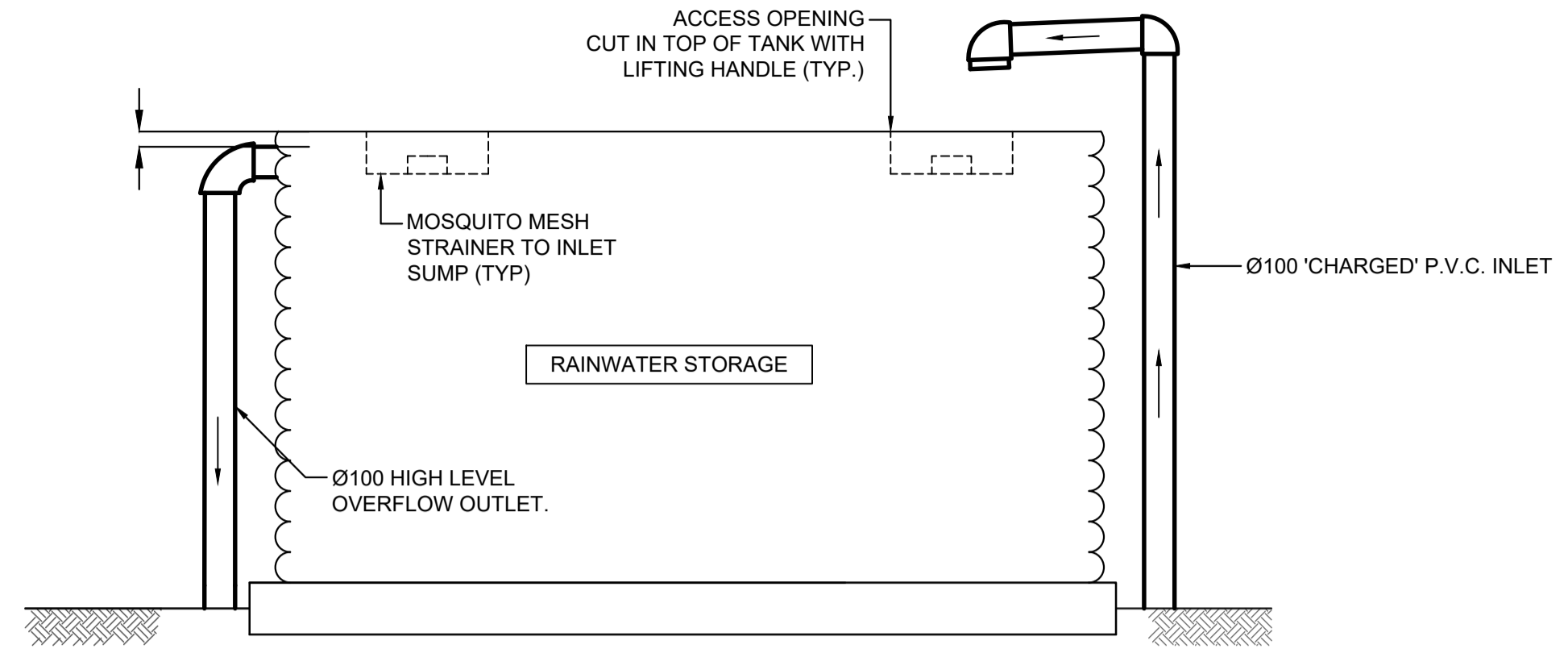

LEGEND:  
BACKGROUND IS YELLOW  
TEXT IS WHITE ON BLACK  
BACKGROUND

DETAIL  
RAINWATER SIGN  
SCALE 1:20

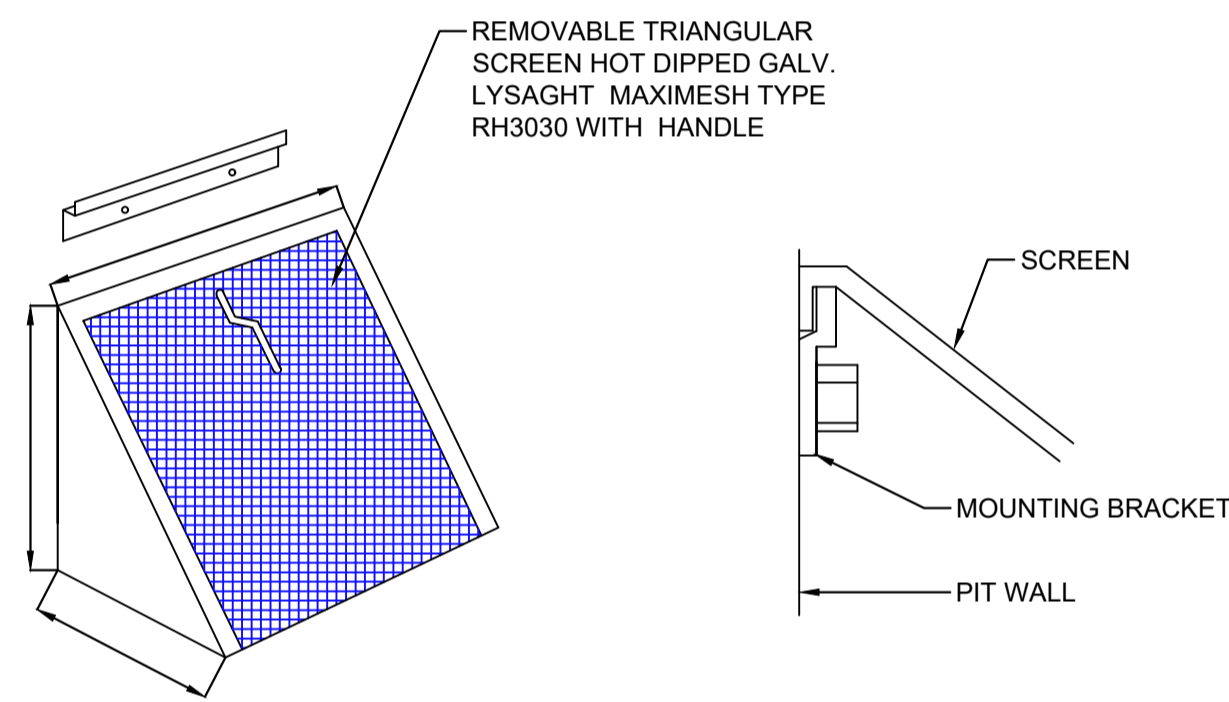

MULTI PURPOSE FILTER SCREEN  
SCALE 1:10

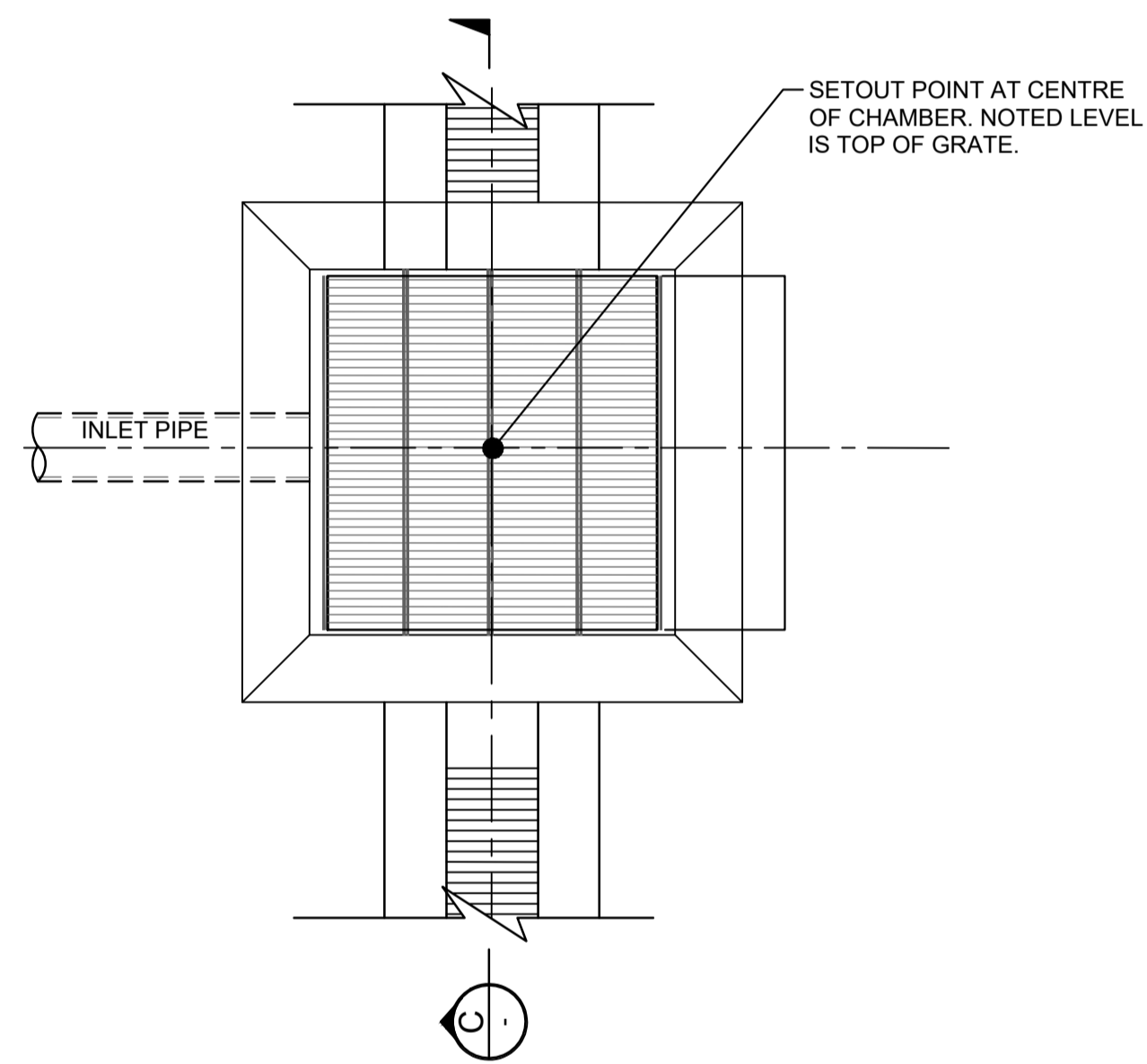

GRADED PIT  
PLAN

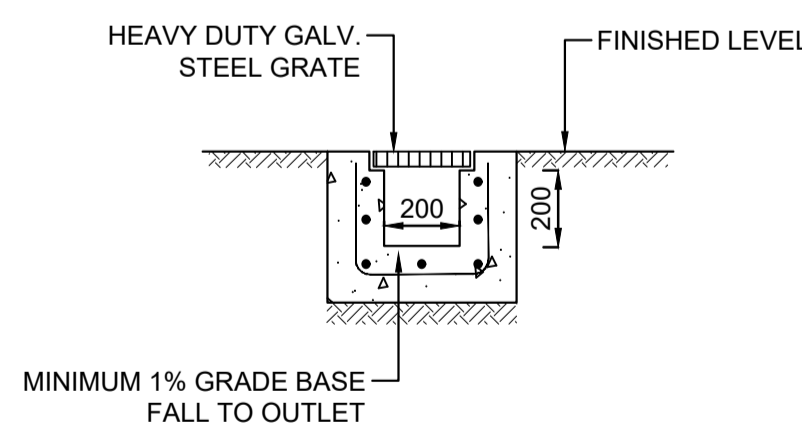

DETAIL  
GRADED TRENCH DRAIN  
SCALE 1:20

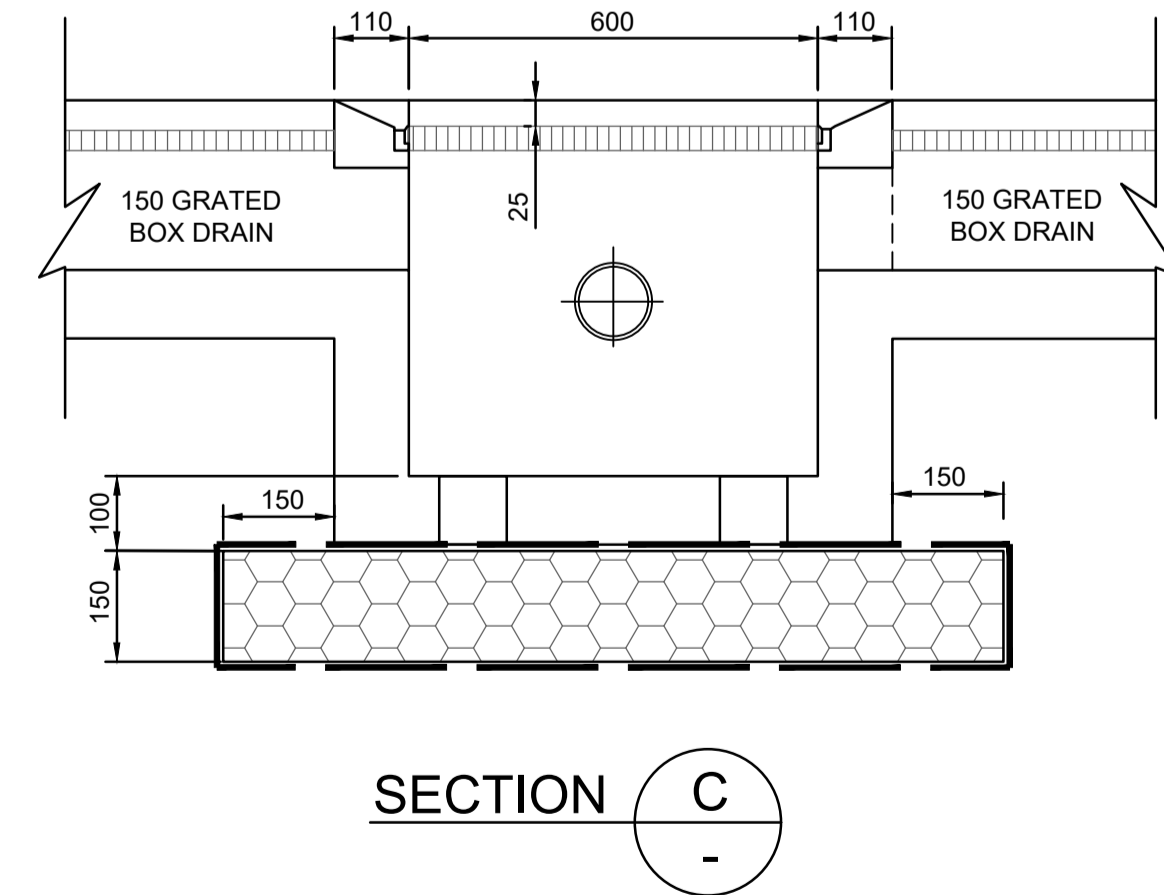

SECTION C

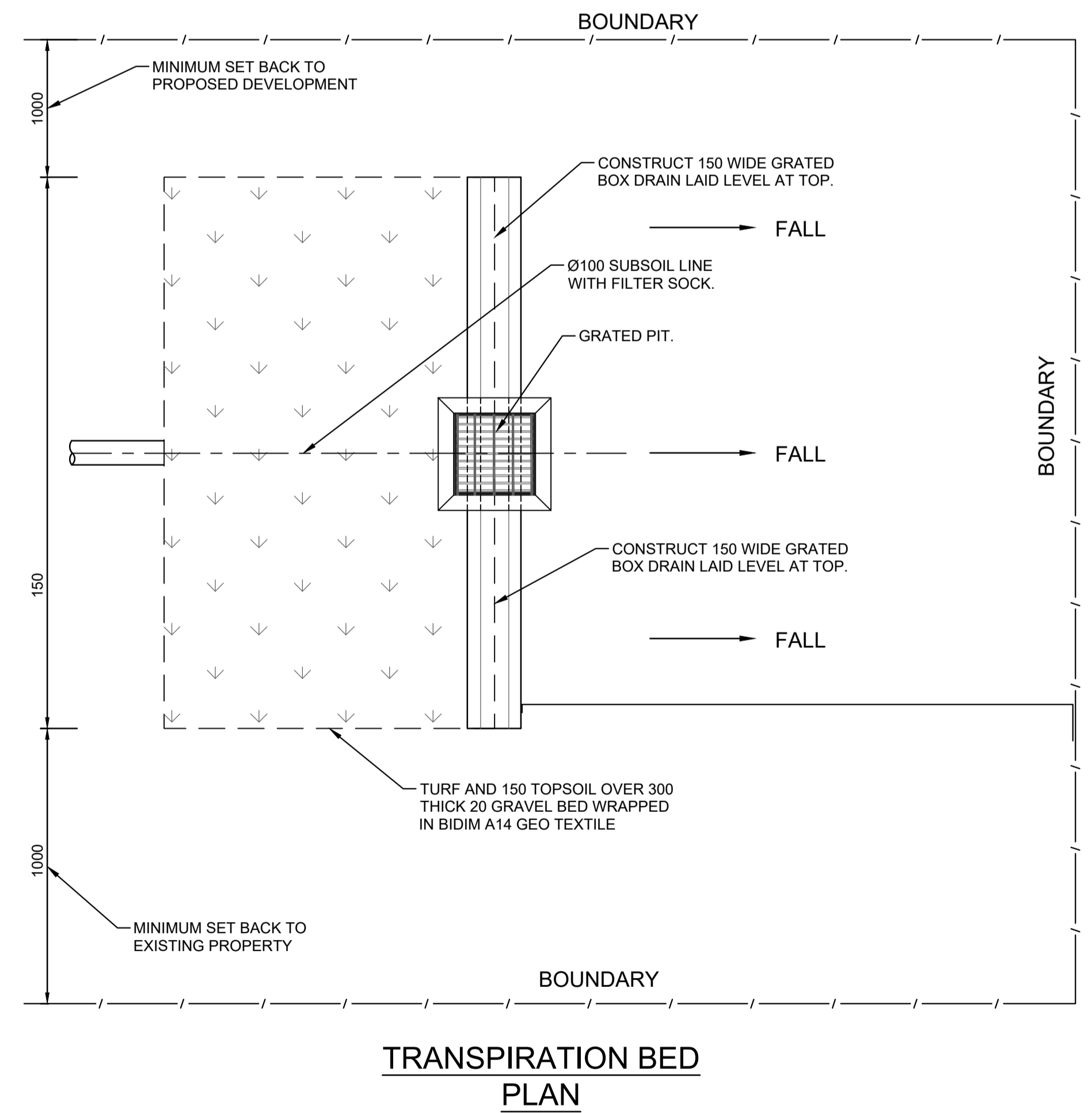

TRANSPIRATION BED  
PLAN

- NOTES :
1. GEOTEXTILE IS TO BE BIDIM A14, PROFEX 4550 OR SIMILAR WITH COEFFICIENT OF PERMEABILITY GREATER THAN 50E-4m/s
  2. ALL DIMENSION ARE IN MILLIMETRES.

No	AMENDMENT	ENG	DRAFT	DATE
A	ISSUED FOR APPROVAL	A.E	J.L.	08.11.21

**ae CONSULTING ENGINEERS**  
 P: 0432 619 949  
 E: info@aeconsulting.com.au  
 W: www.aeconsulting.com.au

ARCHITECT  
**RESOLUT**  
 p: (02) 8003 5885  
 e: info@resolut.com.au

CLIENT  
 TALEB HIJAZI

SHEET SUBJECT  
 STORMWATER DRAINAGE DETAILS

PROJECT 2 MEAGER AVENUE, PADSTOW NSW 2211			
DATE	DRAWN	DESIGNED	CHECKED
08.11.2021	J.L.	J.L.	A.E.
SCALE @ A1		JOB No	
1:100 U.N.O.		D21316	
AUTHORISED		DWG No	REV
A.E.		SW03	A

**ISSUED FOR D.A.**  
 DO NOT SCALE DRAWING, USE FIGURED DIMENSIONS ONLY  
 This drawing remains the property of A.E CONSULTING ENGINEERS and must not be reproduced or used without written consent.